

Note: Part numbers and standards' values may change. Consult LECO for the latest information.

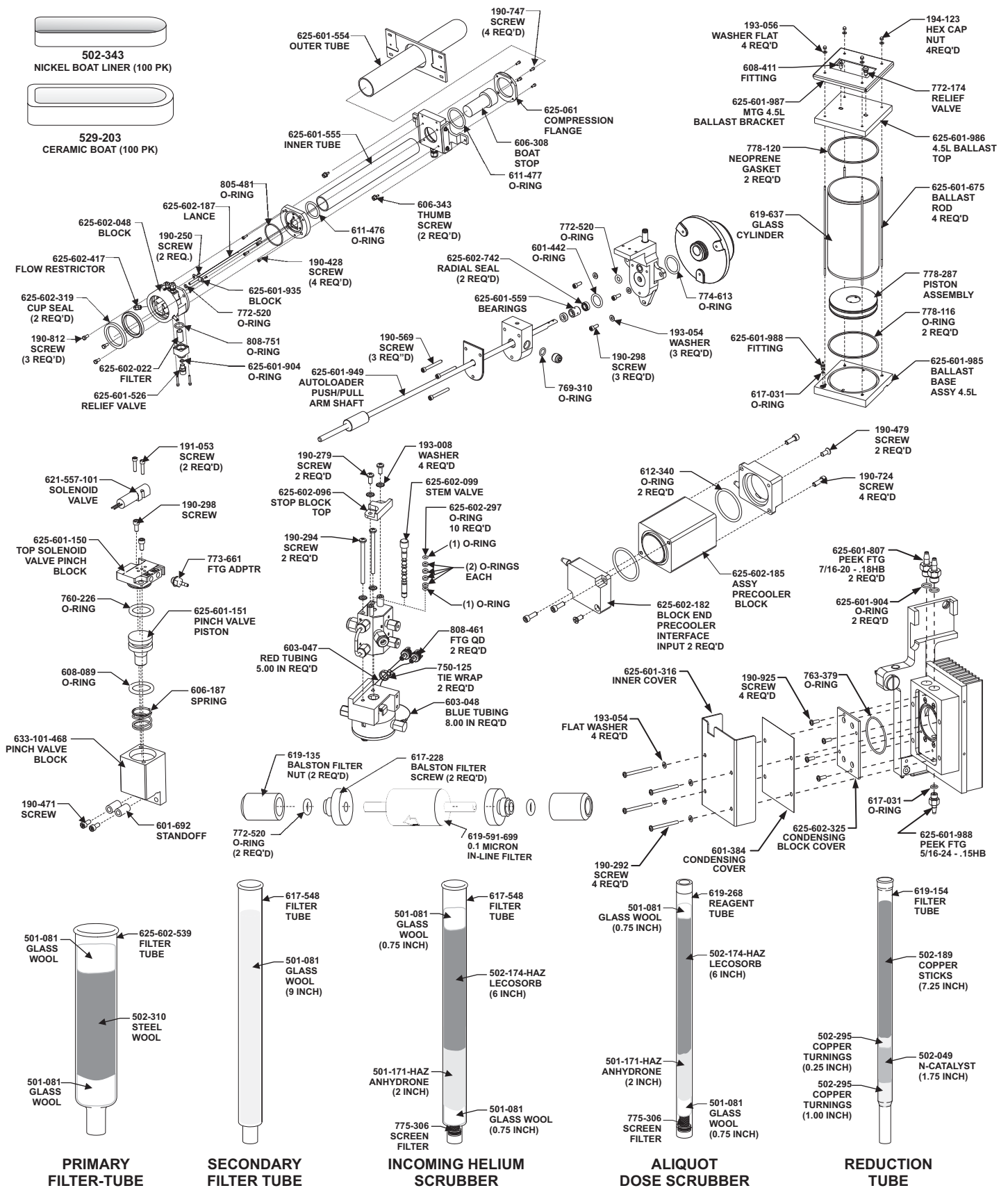

See reverse side for contact information

GENERAL COMBUSTION SUPPLIES

| | |
|-------------|---------------------------------------------------------------------------------|
| 501-171-HAZ | Anhydrone 454 g (1 lb.) bottle |
| 502-189 | Copper Sticks 100 g ampule |
| 502-304 | Copper Sticks 100 g bottle |
| 502-304-500 | Copper Sticks 500 g bottle |
| 502-295 | Copper Turnings 200 g bottle |
| 501-081 | Glass Wool 454 g (1 lb.) box |
| 763-265 | Glass Wool 227 g (0.5 lb.) package |
| 625-602-539 | Furnace Reagent Tube (primary) (O-ring top 773-320, O-ring bottom 772-520) |
| 617-548 | Furnace Reagent Tube (secondary) (O-ring top 765-976, O-ring bottom 772-520) |
| 768-980 | Furnace Particle Filter |
| 619-154 | Reduction Tube (O-ring top 601-442, O-ring bottom 772-520) |
| 775-306 | Screen Filter |
| 619-289 | Purge Tube |
| 619-591-699 | Filter In-Line .01 Micron Disposable |
| 502-174-HAZ | Lecosorb 500 g bottle |
| 502-049 | N-Catalyst 50 g bottle |
| 502-310 | Steel Wool 454 g (1 lb.) |
| 606-308 | Boat Stop, Ceramic |
| 501-426 | ComAid™ for Solids 454 g (1 lb.) bottle |
| 501-427 | ComAid™ for Liquids 454 g (1 lb.) bottle |
| 528-203-250 | Combustion Boat - Ceramic 250/package |
| 502-343 | Nickel Boat Liner 100/package |
| 625-602-470 | Pinch Valve Replacement Tubing kit |
| 601-691 | C-Flex Tubing (25 feet) |
| 625-602-297 | O-ring for aliquot doser stem |
| 611-476 | O-ring inner combustion tube |
| 611-477 | O-ring outer combustion tube |
| 772-520 | O-ring Lance |
| 601-442 | O-ring (reduction Tube, top) |
| 625-601-515 | Combustion Tube Insulation |
| 625-601-554 | Outer Combustion Tube |
| 625-601-555 | Inner Combustion Tube |
| 625-602-187 | Lance Tube |

OPERATION ACCESSORIES

| | |
|-------------|---------------------------------------------------------------------------------------------------------------------------------------------------------------------------------------------------------------------------------------------------------------------------------------|
| 761-929 | Crucible Tongs |
| 613-564 | Expansion Tool for T-Clamps |
| 625-602-512 | Heating Element Replacement Kit includes: (2) 633-101-361 Braided Wire with Clip; (5) 633-101-362 Braided Wire; (1) 625-501-464 Heating Element (6/pkg); (1) 625-602-513 Kit Instructions; (12) 625-501-470 Heating Element Clamp; (12) 633-103-092 Terminal Gasket |
| 502-007 | Tube Cleaner |
| 501-241 | Vacuum Grease |
| 502-213 | Leak Detect Solution |
| 501-614 | Spatula |
| 619-289 | Reagent Purge Tube |
| 501-062 | Boat Puller |
| 502-023 | Funnel |
| 616-513 | O-ring Removal Tool for aliquot doser stem |

SET-UP STANDARDS

| Part No. | Description | % C | % N | Contents |
|-------------|----------------|-------------|------------|----------|
| 501-561-150 | Soy Flour | — | 8.0–10.0 | 50 g |
| 501-563-150 | Corn Flour | — | 0.8–1.6 | 50 g |
| 502-055 | Orchard Leaves | 44.0–52.0 | 2.0–2.8 | 20 g |
| 502-082 | Tobacco Leaves | 35.0–47.0 | 2.0–4.0 | 20 g |
| 502-092 | EDTA | 40.80–41.20 | 49.52–9.60 | 50 g |
| 502-092-250 | EDTA | 40.80–41.20 | 9.52–9.60 | 250 g |
| 502-211 | Glycine | 32.00 | 18.66 | 50 g |
| 502-272 | Corn Gluten | 51.0–53.0 | 11.0–12.0 | 50 g |
| 502-273 | Alfalfa | 45.0–47.0 | 2.5–5.0 | 50 g |
| 502-274 | Wheat Flour | 44.0–46.0 | 2.5–3.5 | 50 g |
| 502-275 | Rye Flour | 43.5–45.5 | 1.5–2.5 | 50 g |
| 502-276 | Oat Meal | 45.0–47.0 | 2.5–3.5 | 50 g |
| 502-277 | Barley | 45.0–47.0 | 1.0–3.0 | 50 g |
| 502-278 | Rice Flour | 43.0–45.0 | 1.0–3.0 | 50 g |
| 501-050 | Nicotinic Acid | 58.53 | 11.4 | 15 g |
| 502-642 | Phenylalanine | 65.4 | 8.5 | 50 g |

CERTIFIED REFERENCE MATERIAL (CRM)

| Part No. | Description | %C | % N | Contents |
|----------|-------------|------|------|----------|
| 502-812 | EDTA | 41.1 | 9.58 | 50 g |

| Part No. | Description | ppm N | Contents |
|----------|----------------------------|-------|-------------|
| 502-601 | Ammonium Chloride Solution | 100 | 5/10 mL Btl |
| 502-602 | Ammonium Chloride Solution | 1000 | 5/10 mL Btl |

SYNTHETIC CARBON SET-UP STANDARDS

| Part No. | Description | %C | Contents |
|----------|------------------|-----------|----------|
| 502-632 | Synthetic Carbon | 0.1–0.2 | 50 g |
| 502-630 | Synthetic Carbon | 0.4–0.60 | 50 g |
| 502-029 | Synthetic Carbon | 0.90–1.10 | 50 g |
| 502-030 | Synthetic Carbon | 4.90–5.10 | 50 g |

SOILS AND ORE TAILING SET-UP STANDARDS

| Part No. | Description | %C | % N | Contents |
|----------|-------------|-----------|-----------|----------|
| 502-062 | Soil | 0.75–1.25 | 0.09–0.15 | 65 g |
| 502-308 | Soil | 2.5–3.5 | 0.2–0.3 | 65 g |
| 502-309 | Soil | 10.0–14.0 | 0.3–1.0 | 65 g |
| 502-814 | Soil | 35–45 | 8.5 | 65 g |
| 502-318 | Ore Tailing | ≤2 | — | 25 g |
| 502-319 | Ore Tailing | 1–5 | — | 25 g |
| 502-320 | Ore Tailing | 2–6 | — | 25 g |
| 502-372 | Ore Tailing | 3–10 | — | 25 g |
| 502-491 | Ore Tailing | 7–15 | — | 25 g |

*Values vary—contact LECO for current levels.

NOTE: Part numbers and standards' values may change.
Consult LECO for latest information.