

Note: Part numbers and standards' values may change. Consult LECO for the latest information.

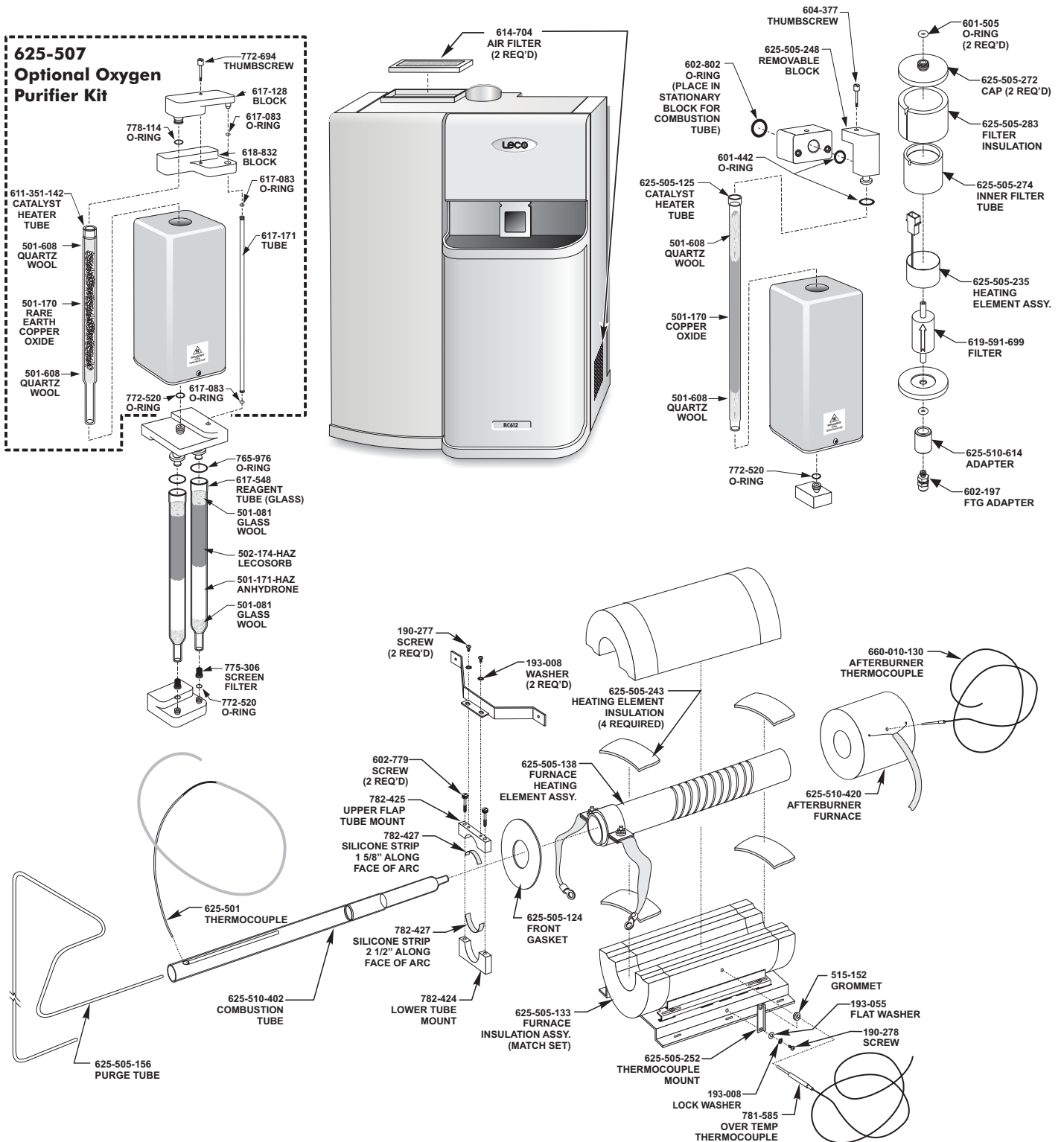

See reverse side for contact information

OPERATING SUPPLIES

781-335 Quartz Boat
782-059 Nickel Boat Liner (10/pkg)
625-505-168 Combustion Tube
625-505-430 Nickel Boats (50/pkg)

CATALYSTS AND REAGENTS

501-171-HAZ Anhydrone 454 g (1 lb.) bottle (10-16 mesh)
501-170 Copper Oxide 50 g bottle
502-156 Fluorhib (1 lb.)
502-493 Fluorhib HP (35 g)
501-081 Glass Wool 454 g (1 lb.) bottle
502-174-HAZ Lecosorb 500 g bottle, (20–30 mesh)
502-176-HAZ Lecosorb 500 g bottle, (8–20 mesh)
501-608 Quartz Wool 200 g bottle

REAGENT TUBES

617-548 Glass Anhydrone Tube, requires two 772-520 O-rings
625-505-125 Quartz Catalyst Heater Tube, requires two
772-520 O-rings

OPERATION ACCESSORIES

780-044 Boat Puller Assembly
761-929 Crucible Tongs
782-508 Quartz Wool Puller/Packing Tool Assembly
501-614 Spatula
625-505-137 Quartz Boat Tweezer

CALIBRATION SAMPLES

501-034 12% Carbon (50 g); Calcium Carbonate
502-029 1% Carbon (50 g); Synthetic Carbon
502-030 5% Carbon (50 g); Synthetic Carbon
502-630 0.5% Carbon (50 g); Synthetic Carbon
502-632 0.1% Carbon (50 g); Synthetic Carbon
502-091 12.3% Moisture (50 g); Calcium Oxalate
501-919 0.33% Moisture (100 g); SARM 4 Norite; SABS

*NOTE: Part numbers and standards' values may change.
Consult LECO for latest information.*

Please Note: Quartz Tubes are typically utilized for higher temperature applications (i.e. catalyst tubes). Glass reagent/filter tubes are designed for lower temperature applications. Glass tubes should not be used in place of quartz tubes.