

Note: Part numbers and standards' values may change. Consult LECO for the latest information.

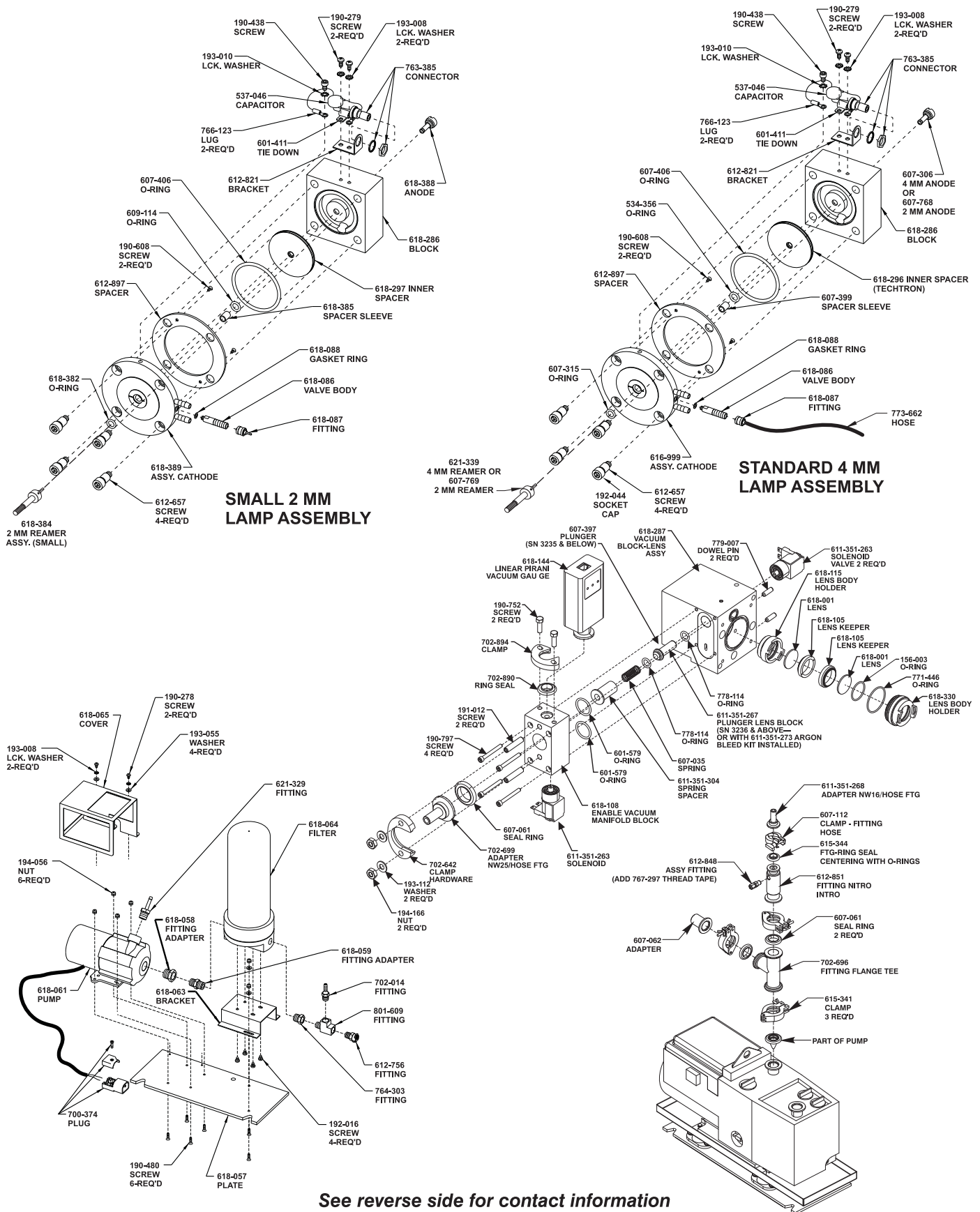

See reverse side for contact information

CONSUMABLES

502-234-HAZ Alcohol
502-237 Foam Wipes (25/pkg)
534-356 Inner Sleeve O-ring (red)
203-913 Printer Paper (5000 sheets)
607-306 Anode, 4 mm
607-315 Outer Sleeve O-ring (blue)
607-399 Lamp Sleeve, 4 mm
621-339 Reamer/Facer Bit Assembly, 4 mm, coated
618-296 Inner Spacer
618-297 Inner Spacer 2 mm (tiny)
607-406 Ceramic Spacer O-ring (red)
156-003 Lens to Keeper O-ring
779-377 Vacuum Pump Oil (400 ml)
502-629 Lens Cleaning Tissue
619-572 Reamer Bit, 4 mm (soft metals)
612-657 Screw Fastener Lamp Delrin
615-797 Swab, Cotton 6"
607-437 Water Tubing, 1 ft. (NOTE: 13 ft. required)
618-242 Bulkhead Tubing Connectors
702-656 Mist Filter

SPARES

618-229 Lamp Rebuild Kit, 2 mm Lamp; Includes
(2) 190-608 Screw, (2) 534-356 O-ring,
(2) 607-315 O-ring, (2) 607-399 Spacer Sleeve
(1) 618-296 Inner Spacer, (1) 607-406
O-ring, (2) 607-768 Anode Removable 2 mm,
(1) 607-769 Assy Reamer/Facer 2 mm,
(4) 612-657 Screw Fastener Lamp Delrin,
(1) 612-897 Spacer Front Lamp 98
618-228 Lamp Rebuild Kit, 4 mm Lamp; Includes
(2) 190-608 Screw, (2) 534-356 O-ring Internal
Lamp, (2) 607-306 Anode 4 mm Removable,
(2) 607-315 O-ring Blue Lamp Face, (2) 607-399
Ceramic Sleeve, (1) 621-339 Reamer/Facer Assy,
(1) 618-296 Inner Spacer, (1) 607-406 O-ring
Large, (4) 612-657 Screw Fastener Lamp Delrin,
(1) 612-897 Spacer Front Lamp
618-158 O-ring Package; Includes (1) 156-003 Lens Holder
Lamp Side, (1) 534-356, Inside Ceramic Sleeve,
(2) 601-579 Vacuum Block/Lens Block,
(4) 607-315 Lamp Outer, (1) 607-406 Ceramic
Spacer (Big), (1) 760-226 Slot on Lens Block,
(1) 771-446 Outside Lens Holder—Lamp Side,
(2) 778-114 Poppet Valve, (1) 779-513 Between
Lamp Block and Lens Block

PRINTER CARTRIDGES

611-227 HP-600, Black
611-228 HP-600, Color
614-459 HP-700/800, Black
614-460 HP-700/800, Color
620-632 HP-950, Color
601-484 Printer Ribbon, Dot Matrix

OPTIONS

607-768-110 2 mm Anode Kit, DC
612-933 Reamer (Drill Kit) - Soft Materials (4 mm Source)
619-580-107 Sample Holder Assembly, 3 mm, Wire
612-798 Sample Holder Assembly, 13 mm, Briquettes
612-774 Sample Holder Assembly, Porous Samples
612-775 Sample Holder Assembly, TRS Bar Holder
607-769 Reamer Assembly, 2 mm
618-390 2 mm Small Lamp Kit (6 mm O-ring); Includes
(2) 190-608 Screws, 607-406 O-ring, 607-771
Reamer Alignment Tool, 609-114 O-Ring,
(4) 612-657 Screws, 612-812 Anode Tool Assy
(2-4 mm), 612-897 Front Lamp Spacer, 618-297
Inner Lamp Spacer, 618-382 O-ring, 618-383
Anode Tool Assy (2 mm), 618-384 Reamer/Facer
Assy, 618-385 Spacer Sleeve, 618-388
Removable Anode, 618-389 Cathode Assy,
618-390-901 Bulletin Lamp Kit, 619-884 Anode
Alignment Tool Assy, 619-885 Spacer Removal
Tool Assy
618-227 2 mm Lamp Kit, Standard Size
611-351-273 Argon Bleed Kit
607-309 Assy Tool Reamer, 4 mm

TOOLS

612-399 Anode Depth Gauge
617-274 Anode Alignment/Sleeve Removal Tool
612-799 Sleeve Removal Tool
618-241 Nut Removal Tool
618-156 Tool Kit; Includes (1) 607-301 Allen Wrench
Set—Hexadecimal, (1) 607-308 Anode Tool 4 mm,
(1) 607-309 Reamer Tool 4 mm, (1) 607-609 Allen
Wrench Set—Hexadecimal (Metric), (1) 607-791
Pump Drain Tube, (1) 612-599 Reamer Alignment
Tool 4 mm, (1) 612-772 Water Drain Tube,
(1) 618-102 Lens Removal Tool, (1) 618-153
Water Fill Tool, (1) 769-491 Adjustable
Wrench—8.0 inch
619-884 Anode Alignment Tool

TOOLS FOR 2 mm SMALL (6 mm O-Ring)

607-771 Alignment Tool
618-383 Anode Tool
619-884 Alignment Tool
619-885 Small Sleeve Removal Tool

NOTE: Part numbers and standards' values may change.
Consult LECO for latest information.