

Note: Part numbers and standards' values may change. Consult LECO for the latest information.

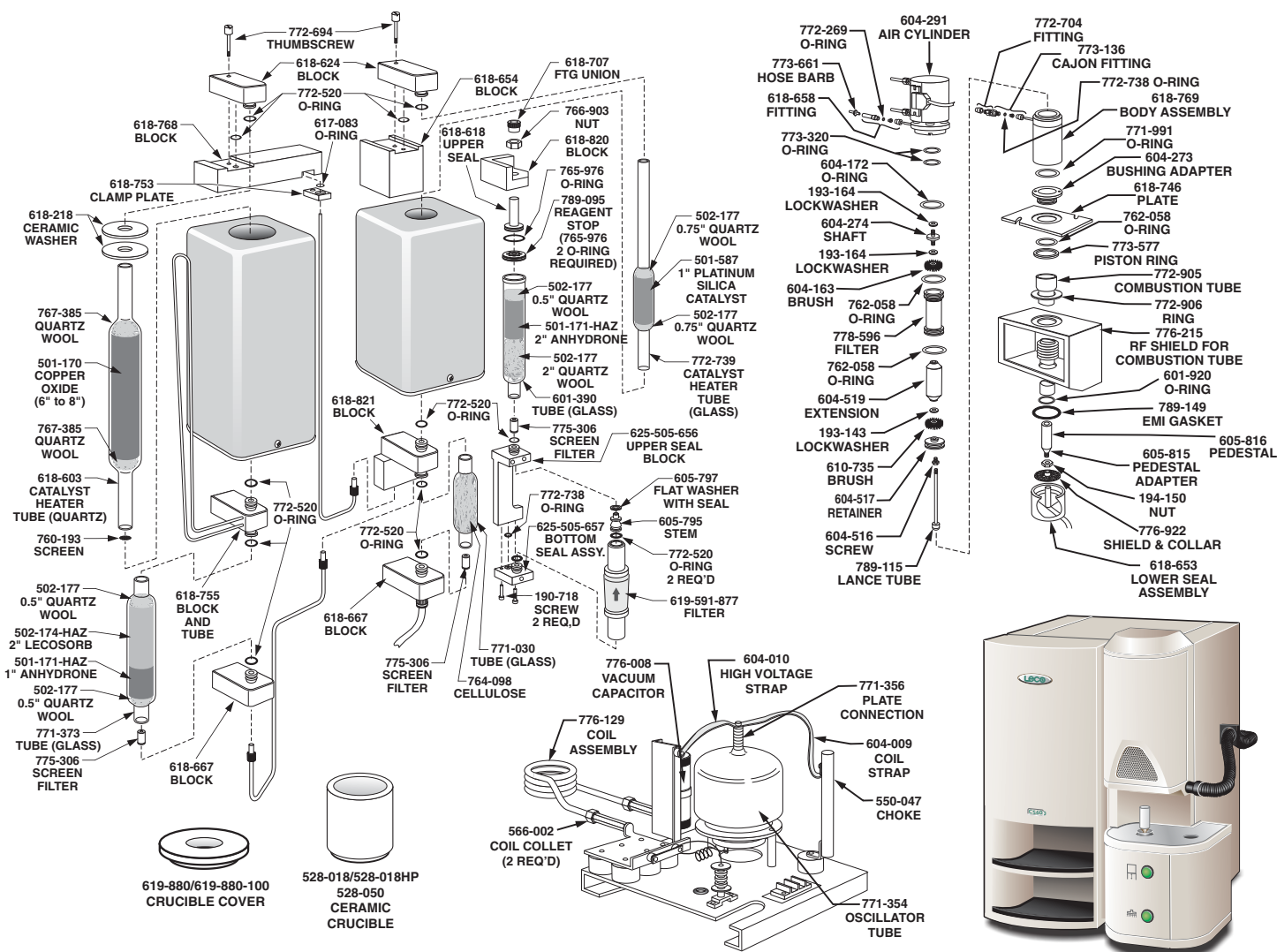

COMBUSTION SUPPLIES

- 528-018 Ceramic Crucible 1000/box
- 528-018HP 0 Sulfur Blank 1000/box
- 528-050 Ceramic Crucible 500/box, bags of 50
- 619-880 Ceramic Crucible Cover with Hole, 1000/box
- 619-880-100 Ceramic Crucible Cover with Hole, 100/box
- 772-905 Combustion Tube (Quartz)
- 778-596 Filter Screen (SST Filter)
- 772-381 Lance Cleaning Wire
- 789-115 Lance Tube (Quartz)
- 610-735 Lower Cleaning Brush (Reworked Brush)
- 762-058 O-ring
- 605-816 Silicon Nitride Pedestal
- 772-906 Teflon Support Ring (Combustion Tube Ring)
- 782-880 Vacuum Cleaner Filter
- 501-082 Wire Cleaning Brush

ACCELERATORS

- 502-492 Copper Accelerator HP (0.44 lb./200 g)
- 501-263 Copper Metal Accelerator 1.36 kg (3 lb.) bottle
- 501-640 Copper Metal Accelerator 9 kg (20 lb.) container
- 501-264 Copper Metal Accelerator, 227 g (0.5 lb.) bottle

ACCELERATORS (cont'd)

- 502-231 High Purity Iron Accelerator 454 g (1 lb.) bottle
- 501-077 Iron Chip Accelerator 0.9 kg (2 lb.) bottle
- 763-026 LECOCEL[®] 13.6 kg (30 lb.) container
- 763-266 LECOCEL[®] 2.27 kg (5 lb.) bottle
- 502-297 LECOCEL[®] II (30 lb./13.6 kg)
- 501-008 LECOCEL[®] II 2.27 kg (5 lb.) bottle
- 502-173 LECOCEL[®] II HP 750 g (1.7 lb.) bottle
- 763-263 LECOCEL[®] III 2.27 kg (5 lb.) bottle
- 763-027 LECOCEL[®] III 13.6 kg (30 lb.) container

CATALYSTS AND REAGENTS

- 501-171-HAZ Anhydron 454 g (1 lb.) bottle
- 764-098 Cellulose 454 g (1 lb.) package
- 502-174-HAZ Lecosorb 500 g bottle, 20-30 mesh
- 502-176-HAZ Lecosorb 500 g bottle, 8-20 mesh
- 501-587 Platinum/Silica 15 g bottle
- 502-177 Quartz Wool 50 g package
- 501-170 Rare Earth Copper Oxide 50 g bottle

Please Note: Quartz Tubes are typically utilized for higher temperature applications (i.e. catalyst tubes). Glass reagent/filter tubes are designed for lower temperature applications. Glass tubes should not be used in place of quartz tubes.

See reverse side for contact information

REAGENT TUBES

- 771-030 Glass Tube, requires two (2) 772-520 O-rings for sealing
771-373 Glass Tube, requires two (2) 772-520 O-rings for sealing
618-603 Quartz Catalyst Tube, requires two (2) 772-520 O-rings for sealing, and a 772-738 O-ring for the removable block
772-739 Glass Catalyst Tube, requires two (2) 772-520 O-rings for sealing, and a 772-738 O-ring seals the removable block

OPERATION ACCESSORIES

- 619-591-877 Balston Filter
761-929 Crucible Tongs
789-149 EMI Gasket
775-307 Filter Removal Tool (Thumbscrew)
775-306 Secondary Filter, 10 micron
503-032 Glass Accelerator Scoop
773-579 Metal Accelerator Scoop
764-078 One gram Weight
760-138 Sample Tweezers
619-825 Trap Tube for CSLS600 (only)
501-241 Vacuum Grease

*NOTE: Part numbers and standards' values may change.
Consult LECO for latest information.*

United States:

**Ph: 1-800-292-6141
Fax: 269-982-8977**

Canada:

**Ph: 1-800-268-0215
Fax: 905-564-6582**

represented by:

Other Countries:

**Ph: 269-983-5531
Fax: 269-983-3850**

© 2011 LECO Corporation