

Note: Part numbers and standards' values may change. Consult LECO for the latest information.

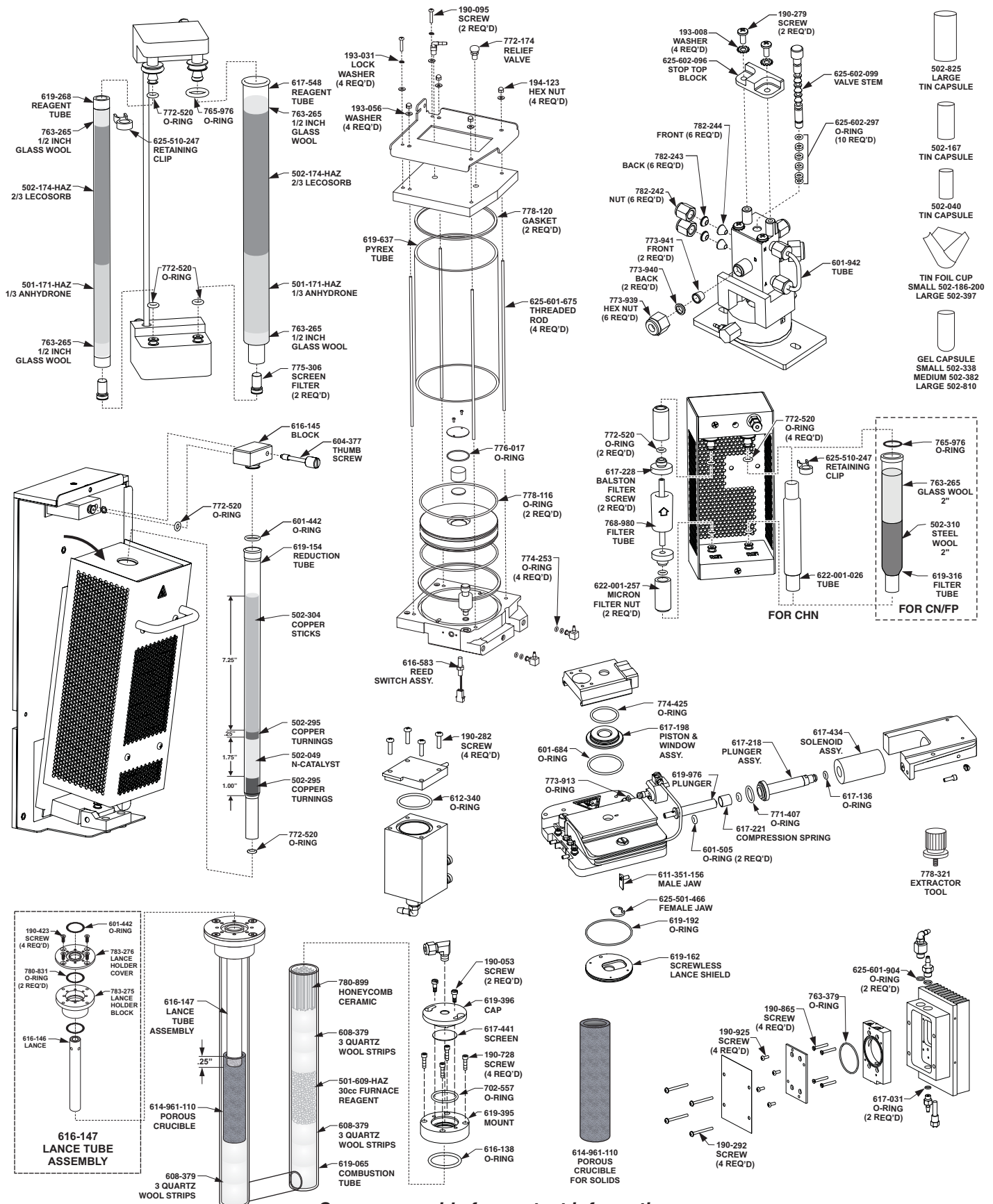

See reverse side for contact information

GENERAL COMBUSTION SUPPLIES

501-171-HAZ	Anhydrous 454 g (1 lb.) bottle
502-189	Copper Sticks 100 g ampule
502-304	Copper Sticks 100 g bottle
502-304-500	Copper Sticks 500 g bottle
502-295	Copper Turnings 100 g bottle
501-081	Glass Wool 454 g (1 lb.) box
763-265	Glass Wool 227 g (0.5 lb.) package
502-174-HAZ	Lecosorb 500 g bottle
502-049	N-Catalyst 50 g bottle
608-379	Quartz Wool Strips 10/pkg
502-310	Steel Wool 454 g (1 lb.)
501-609-HAZ	Furnace Reagent
625-602-470	Ballast C-Flex Replacement Assembly

CAPSULES AND CRUCIBLES

502-338	Gel Capsule, Small 400/pkg
502-382	Gel Capsule, Medium 400/pkg
502-810	Gel Capsule, Large 400/pkg
614-961-110	Porous Crucibles for solids 10/pkg
617-605	Porous Crucibles for liquids 10/pkg
502-040	Tin Capsules, Small 100/bottle
502-040-100	Tin Capsules, Small 1000/bottle
502-167	Tin Capsules, Medium 100/bottle
502-825	Tin Capsules, Large 50/bottle
502-186-200	Tin Foil Cups, Small 100/bottle
502-186-100	Tin Foil Cups, Small 1000/bottle
502-397	Tin Foil Cups, Large 100/bottle
502-397-400	Tin Foil Cups, Large 400/bottle

OPERATION ACCESSORIES

502-007	Tube Cleaner
601-981	Wire Brush
616-152	Crucible Extractor Tool
775-306	Secondary Filter, 10 micron
775-307	Filter Tool, Thumbscrew
502-023	Funnel Quick Disc
778-321	Lance Extraction Tool
502-213	Leak Detection Solution
601-470-110	Liquid Injector Kit, Manual
762-515	O-ring Tool - Removal
616-513	O-ring Tool - Installation
616-504	Particle Filter
604-398	Sample Cup Holder, Large
604-373	Sample Cup Holder, Small
601-490-110	Sample Foiler Kit
778-405	10-Sample Storage Block
501-614	Spatula
619-180-110	Stackable Carousel Assembly
502-028	Tweezers
604-378	Tweezers, Curved (SST)
501-241	Vacuum Grease
619-380	Vacuum Cleaner Attachment Assembly
619-377	Bypass Plate

COMBUSTION TUBES AND GLASSWARE

601-390	Glass Filter Tube (wide mouth top, small bottom) requires one (1) 765-976 Top O-ring and one (1) 772-520 Bottom O-ring for sealing
622-001-026	Glass Filter Tube (small mouth top and bottom) requires 772-520 O-rings for sealing
619-268	Reagent Tube, requires 772-520 O-rings for sealing
619-154	Reduction Tube, requires 601-442 O-rings for sealing
780-899	Honeycomb Ceramic Stop
619-065	Combustion Tube
617-441	Screen Filter
617-548	Reagent Tube, requires 765-976 Top O-ring and 772-520 Bottom O-ring for sealing

*Values vary—contact LECO for current levels.

NOTE: Part numbers and standards' values may change.
Consult LECO for latest information.

NATURAL MATRIX SET-UP STANDARDS

Part No.	Description	% C	% H	% N	% S	Contents
501-561-150	Soy Flour	—	—	8.0–10.0	—	50 g
501-563-150	Corn Flour	—	—	0.8–1.6	—	50 g
502-055	Orchard Leaves	44.0–52.0	5.7–6.5	2.0–2.8	0.15–0.25	20 g
502-082	Tobacco Leaves	35.0–47.0	4.0–7.0	2.0–4.0	0.3–0.8	20 g
502-272	Corn Gluten	51.0–53.0	7.0–7.5	11.0–12.0	0.75–1.0	50 g
502-273	Alfalfa	45.0–47.0	5.5–6.5	2.5–5.0	0.25–0.35	50 g
502-274	Wheat Flour	44.0–46.0	6.0–7.0	2.5–3.5	0.15–0.25	50 g
502-275	Rye Flour	43.5–45.5	6.0–7.0	1.5–2.5	0.10–0.20	50 g
502-276	Oat Meal	45.0–47.0	6.0–7.0	2.5–3.5	0.15–0.25	50 g
502-277	Barley	45.0–47.0	6.0–7.0	1.0–3.0	0.10–0.20	50 g
502-278	Rice Flour	43.0–45.0	6.0–7.0	1.0–3.0	0.10–0.20	50 g

PURE CHEMICAL SET-UP STANDARDS

Part No.	Description	% C	% H	% N	% O	Contents
501-050	Nicotinic Acid	58.53	4.09	11.38	—	15 g
502-092	EDTA	40.80–41.20	5.46–5.54	9.52–9.60	—	50 g
502-211	Glycine	32.00	6.71	18.66	42.63	50 g
502-642	Phenylalanine	65.4	6.7	8.5	—	50 g

COAL AND COKE REFERENCE MATERIALS

Part No.	Description	% Sulfur	% C	% H	% N	Contents
502-680	Coal Prox Plus Low	~0.3	~81.0	~4.0	~1.0	50 g
502-681	Coal Prox Plus Med.	~1.3	~78.0	~5.0	~1.5	50 g
502-682	Coal Prox Plus High	~0.5	~75.0	~5.0	~1.5	50 g
502-683	Met Coke Prox Plus	~0.75	~87.0	~0.3	~1.0	50 g
502-684	Pet Coke Prox Plus	~5.5	~87.0	~3.6	~1.5	50 g

CERTIFIED REFERENCE MATERIALS

Part No.	Description	% S	% C	% H	% N	Contents
502-812	EDTA CRM	—	~41.1	~5.55	~9.56	50 g
502-815	Mineral Oil CRM	—	~86.0	~13.80	—	118 ml (4 oz.)
502-816	Residual Fuel Oil	~3.0	~86.0	~10.0	~0.3	118 ml (4 oz.)
502-831	QAR CRM Coal 1	1.5	74.6*	4.8	1.7	50 g
502-832	QAR CRM Coal 2	0.25	70.0*	4.0	0.9	50 g
502-833	QAR CRM Coal 3	0.34	81.0*	4.01	1.1	50 g
502-834	QAR CRM Coal 4	0.30	68.5*	4.3	0.9	50 g
502-835	QAR CRM Coal 5	0.5	68.5*	5.0	1.7	50 g
502-836	QAR CRM Coal 6	3.99	70.2*	4.9	1.3	50 g
502-837	QAR CRM Coal 7	3.26	72.6*	4.9	1.4	50 g
502-838	QAR CRM Coal 8	0.7	68.5*	4.9	1.2	50 g
502-839	QAR CRM Coal 9	2.1	77.5*	5.1	1.5	50 g

*For information purposes only.